

FITTING FORM

Turnkey booths - 4x4 m

STANDARD € 75.00 per m²

CORNER POSITION

2 open sides

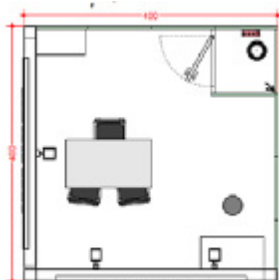

- Technical view -

IN-LINE POSITION

1 open side

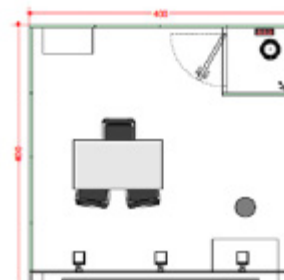

- Technical view -

The **STANDARD** fitting is also available for bigger surfaces with more open sides

FITTINGS SPECIFICATIONS

- * Fireproof carpeting with protective film. Colour grey
- * Panels height 300cm water-based paint color white, 5 cm thick, maximum load of 15 Kg.
- * Columns 20x20cm section, height 280cm, water-based paint color bordeaux
- * Beam 20x20cm section, water-based paint color bordeaux

N.B.

- * Corner booths: 2 trapezoidal rands length 300cm, height 40cm.
- * In-line booths: 1 trapezoidal rand length 300cm, height 40cm
- * Prespaced company name, printable area 200x30cm.

ELECTRICAL SYSTEM

- * Electric panel and wiring
- * 3 halogen lamps 300W
- * 1 outlet 220v

FURNITURE

- * N° 1 reception desk 130x50x100cm
- * N° 1 stool
- * N° 1 rectangular desk 135x75cm.
- * N° 3 black padded chairs
- * N° 1 lockable cabinet 40x76xh79 cm.
- * N° 1 coat hook
- * N° 1 wastepaper basket
- * storage room 100x100cm with lockable door

MULTIPLE MODULS FURNISHINGS

in case of multiple modules, standard furnishing, lamps and outlets will be multiplied by the modules number.

Technical support guaranteed during the show days.

ATTENTION!
Pre-equipped booths must be handed back on March 28, 2020 by 10pm

BOOTHS HANDOVER: MARCH 25, 2020 FROM 8 AM

The measurements given, the colors and the images are only indicative and may not reflect the assigned stand. The panels can not be drilled if not in the heads and edges with small nails. Any damage will be charged to the exhibitor (to hang, we recommend the use of chains) Please note that any application of expansion plugs and stickers to goods and panels is prohibited. Any need can be agreed with the organizing secretariat and the stand builder. All liability resulting from unauthorized tampering of the structures, not authorized decorations damaging rented goods, will be charged to the customer at final balance. Any requests for changes made after the date of confirmation of the booth will be evaluated and quoted separately. We will not accept requests for structural change in the three days prior to the show beginning. For more details please do contact the Organizing Secretariat.